

**SURVEYOR'S CERTIFICATE**

I HEREBY CERTIFY THAT I AM A REGISTERED PROFESSIONAL LAND SURVEYOR IN THE STATE OF ALASKA AND THAT THIS RECORD OF SURVEY REPRESENTS A SURVEY MADE BY ME OR UNDER MY DIRECT SUPERVISION AND THAT THE MONUMENTS SHOWN ON THE PLAT ACTUALLY EXIST AS DESCRIBED, AND THAT ALL DIMENSIONAL AND OTHER DETAILS ARE TRUE AND CORRECT TO THE BEST OF MY KNOWLEDGE.

ROBERT S. HOFFMAN, P.L.S. 12/2/20  
 LS 10609 PROFESSIONAL LAND SURVEYOR DATE



**RECORD OF SURVEY**

THE SW 1/4 SE 1/4 AND S 1/2 NW 1/4 SE 1/4 GOVERNMENT LOT 1 OF SECTION 9 AND GOVERNMENT LOT 3 OF SECTION 10 TOWNSHIP 15 NORTH, RANGE 3 WEST SEWARD MERIDIAN, ALASKA PALMER RECORDING DISTRICT THIRD JUDICIAL DISTRICT STATE OF ALASKA

**BULL MOOSE SURVEYING**  
 ROBERT S. HOFFMAN, P.L.S.  
 200 HYDRATE LANE OFFICE (907) 357-  
 WAILLA, ALASKA 99654 bob@bullmoosesurvey.com

DRAWN BY: EEG	DRAWING SCALE
DATE: 12/2/2020	1"=200'
CHECKED BY: BSM	JOB NAME: SHEET

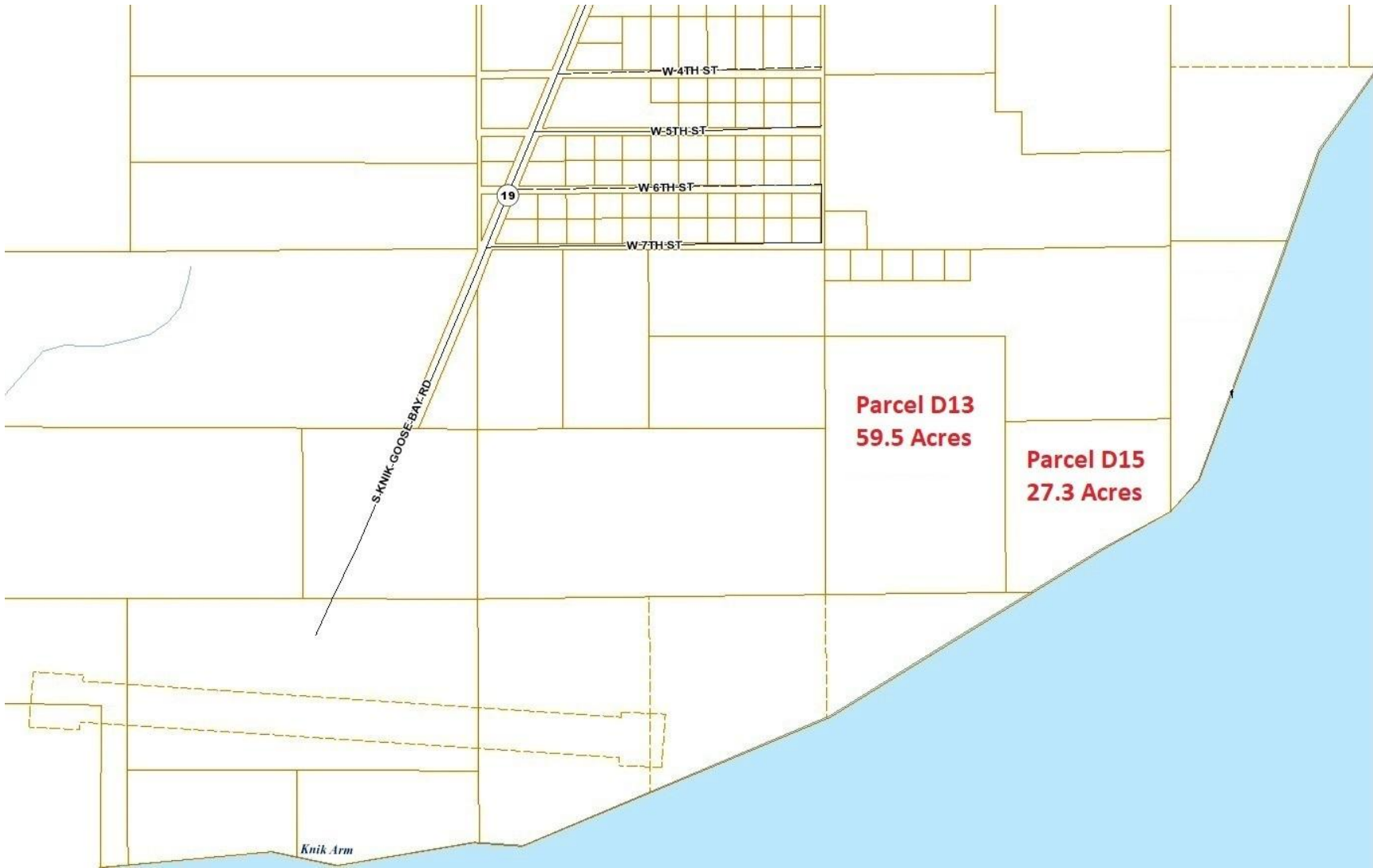

W 4TH ST

W 5TH ST

W 6TH ST

W 7TH ST

19

S KNIK GOOSE BAY RD

**Parcel D13  
59.5 Acres**

**Parcel D15  
27.3 Acres**

*Knik Arm*

